



MOUNT  
VERNON

TRIANGLE ◀ DC

---

IT'S ALL HERE

# **Request for Public Space Permit for New Bike Corral at 555 Mass Ave NW**

Presentation to Advisory  
Neighborhood Commission 6E  
by Mount Vernon Triangle  
Community Improvement District

January 9, 2024

**The Ask: ANC 6E Support for a  
Public Space Permit for New Bike  
Corral at 555 Mass Ave NW**

# Why Project Needed





JOE

1000

NO PARKING  
ANY TIME  
IN THIS ZONE

NO PARKING  
ANY TIME  
IN THIS ZONE

1000









**Proposed Solution: Micro-Mobility  
Corral, Flexploats & Striping  
(includes tree protection + traffic  
control per DDOT standards)**

# 555 Mass Ave

Pizza Shop

(Two trees to be protected during construction per notes)

Micro-mobility corral

Flexposts and striping

# 5th Street NW

555 Mass Ave - No Parking Zone

Livable City Group 9-28-23

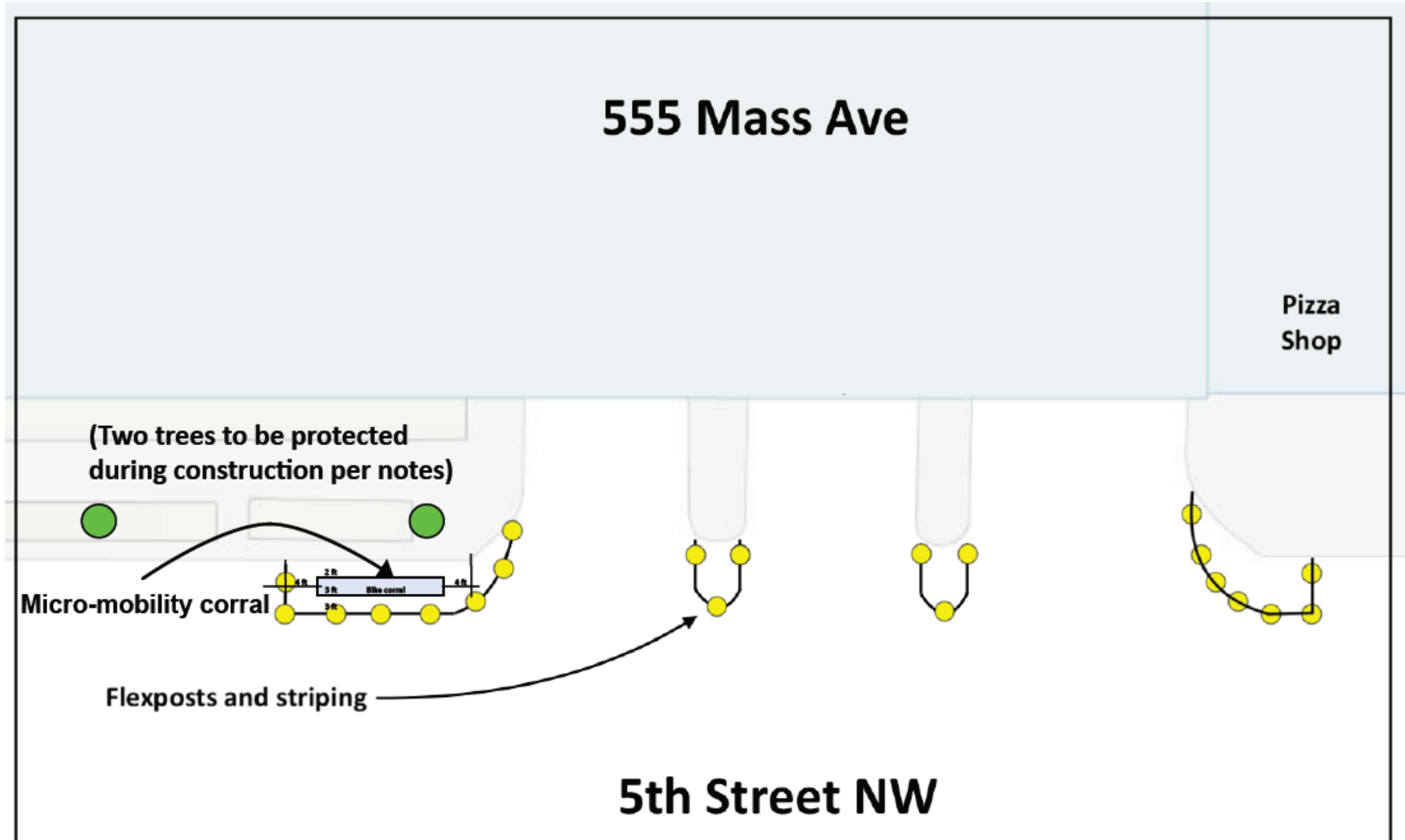

# Legend

- Bus Stop
  - FIRE HYDRANT
  - Work Area
  - Direction of Vehicle Travel
  - Sign Stand
  - Cone
- ALL SIGNS WILL BE PLACED ON STANDS**

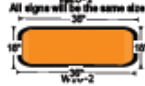

Building management will be informed of limited access to parking garage

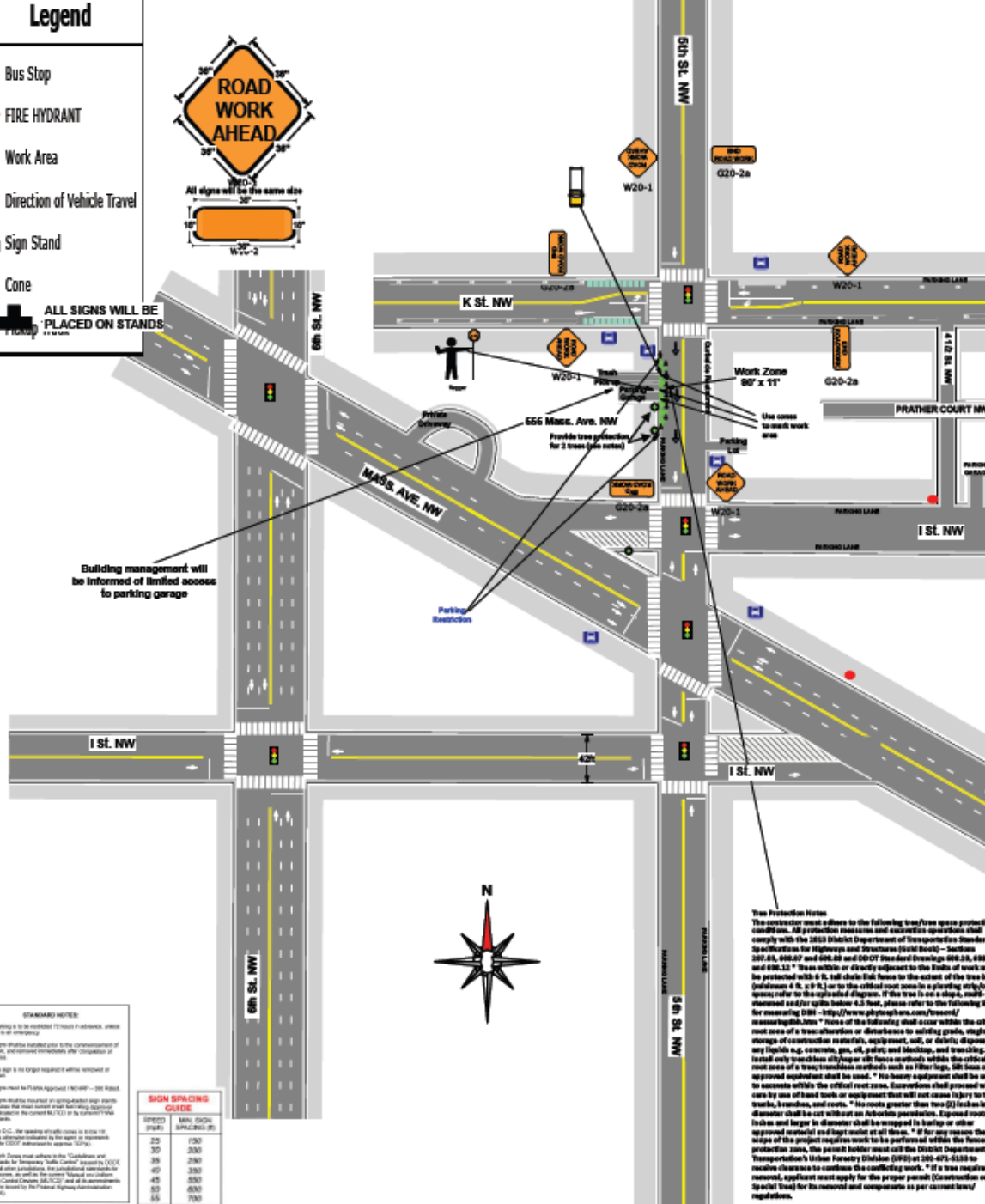

### STANDARD NOTES

1. Paving to be done between 6:00 AM and 6:00 PM.
2. Sign stands approved after the completion of all work, and approved immediately after completion of work.
3. If a sign is no longer required, remove it immediately.
4. Sign stands to be placed on stands 1' high.
5. Sign stands to be placed on stands 1' high.
6. Sign stands to be placed on stands 1' high.
7. Sign stands to be placed on stands 1' high.
8. Sign stands to be placed on stands 1' high.
9. Sign stands to be placed on stands 1' high.
10. Sign stands to be placed on stands 1' high.

### SIGN SPACING GUIDE

SPEED (MPH)	MIN. SIGN SPACING (FT)
25	150
30	200
35	250
40	300
45	350
50	400
55	450

**Tree Protection Notes**  
 The contractor must adhere to the following tree/tree space protection conditions. All protection measures and execution operations shall comply with the 2023 District Department of Transportation Standard Specifications for Highways and Structures (District Book) - Sections 207.01, 600.07 and 600.02 and DOT Standard Drawing 000-28, 698.13, and 698.12. Trees within or directly adjacent to the limits of work must be protected with a 6 ft. tall chain-link fence to the extent of the tree base (minimum 4 ft. x 4 ft.) to the critical root zone in a planting, early/young space; refer to the attached diagram. If the tree is on a slope, make necessary soil/grade before 4:30 AM. Please refer to the following link for measuring DIB - <http://www.photogram.com/measure/high.htm>. None of the following shall occur within the critical root zone of a tree: alteration or disturbance to existing grade, storage of construction materials, equipment, soil, or debris; disposal of any liquids (e.g., concrete, gas, oil, paint); and blocking, and trenching. Install only chain-link fencing with fence standards within the critical root zone of a tree; translucent materials such as Fiberglass, SR-20 or an approved equivalent shall be used. No heavy equipment shall be used to excavate within the critical root zone. Excavations shall proceed with care by use of hand tools or equipment that will not cause injury to tree trunks, branches, and roots. No roots greater than two (2) inches in diameter shall be cut without an arborist's permission. Excavations 2 inches and larger in diameter shall be wrapped in burlap or other approved material and kept moist at all times. If for any reason the edges of the project require work to be performed within the fenced protection zone, the permit holder must call the District Department of Transportation's Urban Forestry Division (UFD) at 202-471-6539 to receive clearance to continue the conflicting work. If a tree requires removal, applicant must apply for the proper permit (Construction or Special Use) for its removal and compensate as per current laws/regulations.

**Professional Autoturn Analysis  
Confirms No Impediment to 555  
Mass Garage/Loading Access &  
Prost Streatery**

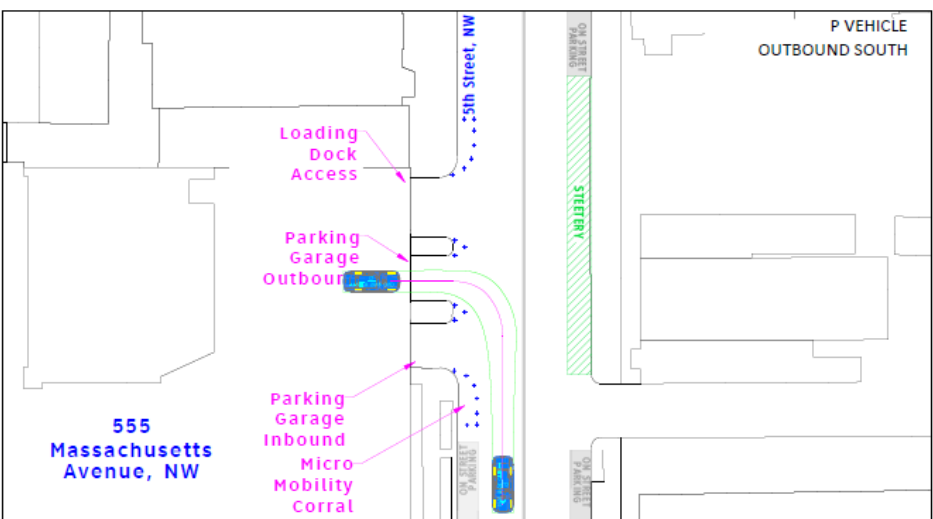
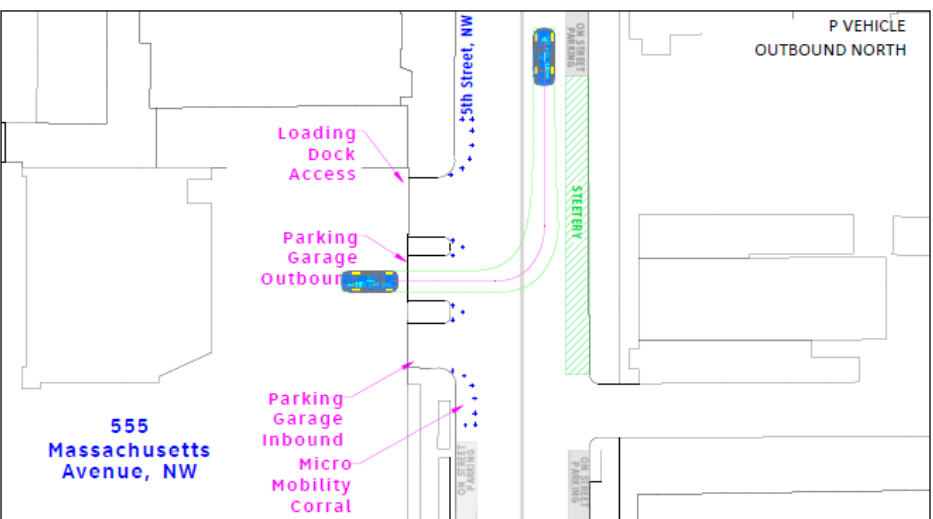
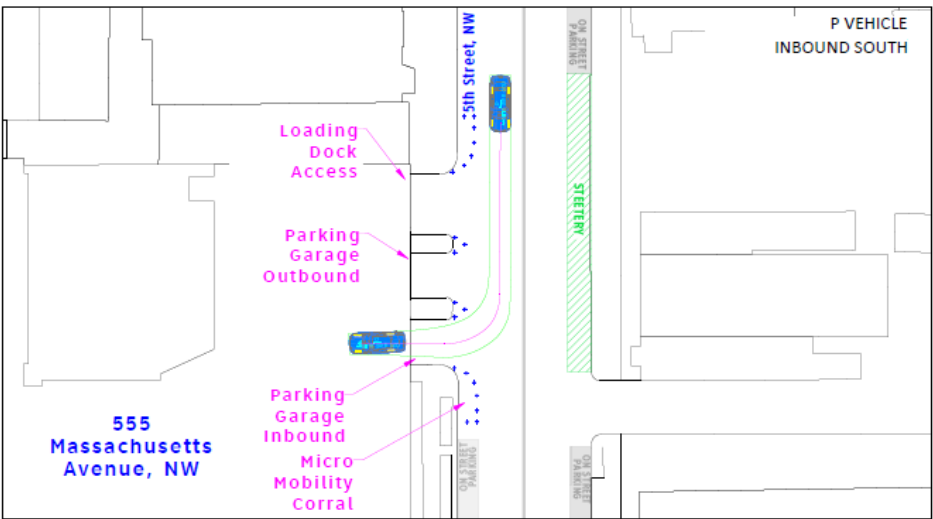
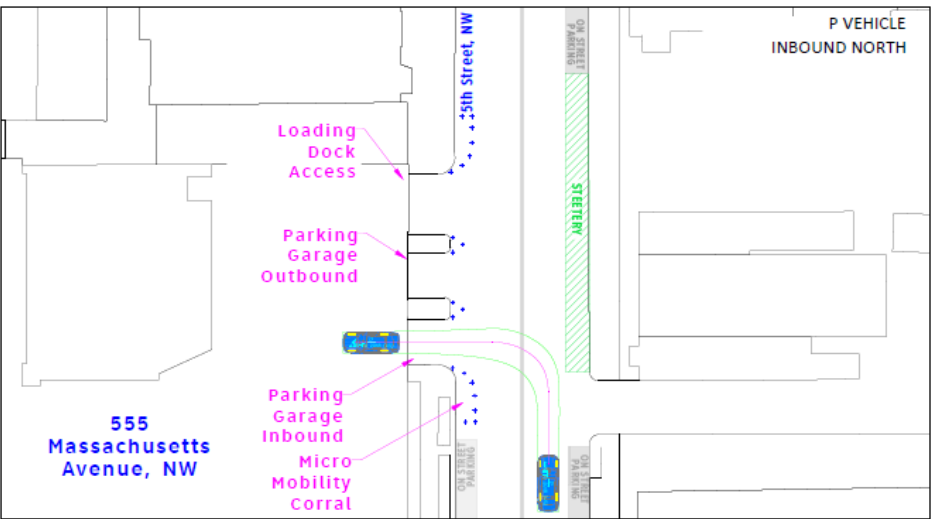



MOUNT  
VERNON  
TRIANGLE • DC

IT'S ALL  
**HERE.**

info@mvtcid.org  
mountvernontriangle.org

@mvtcid

